

QR110

QR Code and Card Reader
for Access Control

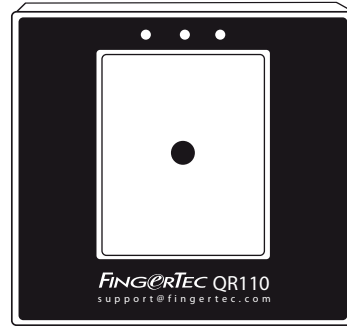

Installation Guide

1 INTRODUCTION

QR110 is a QR code scanner that works as a slave terminal for door access control system, where it captures the QR Code, converts it into a numeric code and sends this information to the master terminal for verification. QR110 communicates with the master terminal via Wiegand 26-bit output and requires the master terminal to have a Wiegand 26-bit input as well in order to be able to accept signals from QR110

LED Light Indicator

1. First LED
Green light indicates that the device is on standby.
2. Second LED
Green light indicates that the card information is being read and sent to the master terminal for verification.
3. Third LED
Red light indicates that the device is connecting to the master device. The light indicator will then change to green color if the connection is successful.

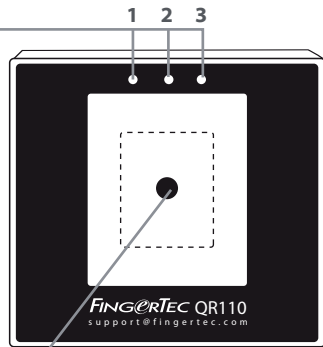

Card Scanning Area
Scan a card at this area for verification.
Default card type:
RFID Card, 125kHz 40 to 80mm
Made to order:
MIFARE, 13.56MHz 30 to 50mm

QR code scanner
Scan the QR code at this area for verification.

SPECIFICATIONS	
MODEL	QR110
DIMENSION (L X W X H), mm	86 x 40 x 86
CREDENTIALS	QR Code RFID EM Card 125KHz MiFare Card 13.56MHz (Made to order)
OUTPUT FORMAT	Wiegand 26/34
COMMUNICATION DISTANCE	Wiegand <100m RS485 < 1200m
WORKING VOLTAGE	DC 9 ~ 16V
WORKING CURRENT	< 100mA
WORKING ENVIRONMENT	-10C ~ 70 C
SENSING DISTANCE	QR Code: 3~10cm Cards: 2~3cm
READING SPEED	< 0.2 seconds
READING INTERVAL	<0.5 seconds
SUPPORT	Q2i, R2, R3, Face ID 3, Kadex, m-Kadex, Ingressus I/II/IV

NOTE: Specifications are subject to change. Check <http://product.fingertec.com> for latest product information.

© 2018 Timetec Computing Sdn Bhd. All rights reserved · 042018



QR Code



Card



RoHS

2 Connections & Wiring Diagram

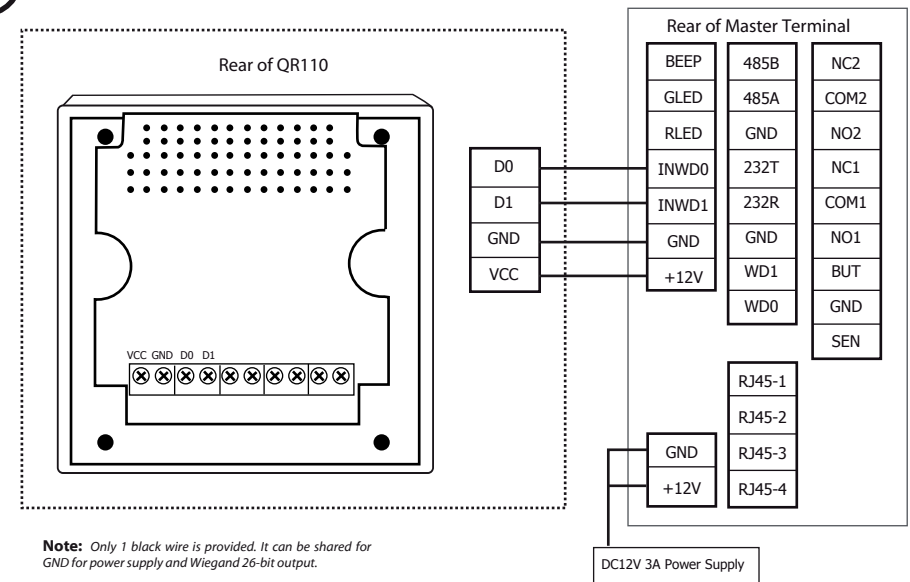

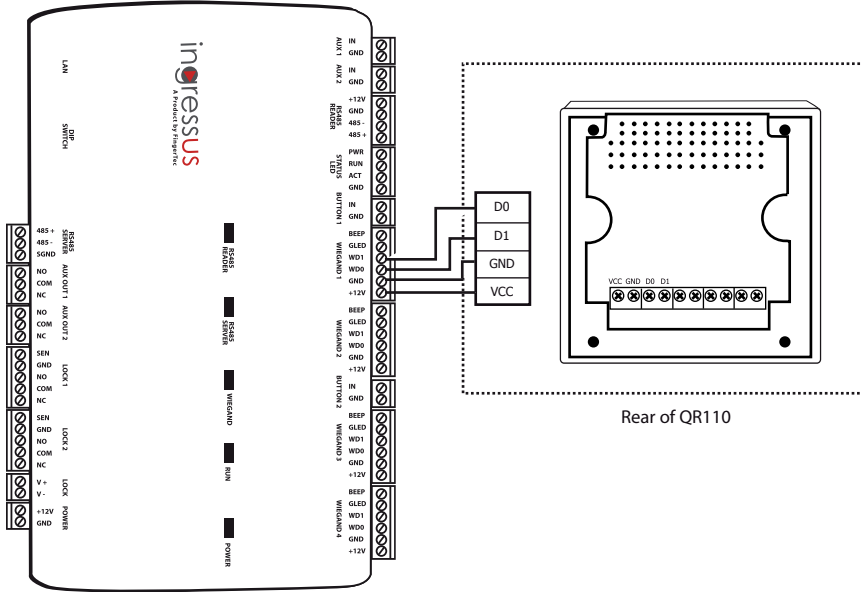

3 Installation

QR110 is powered by the master terminal, thus no extra power supply is required.

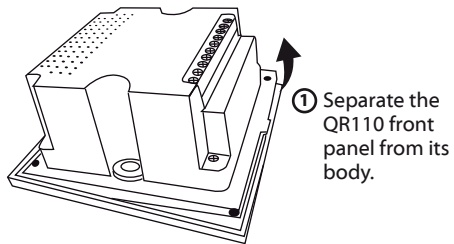

1 Separate the QR110 front panel from its body.

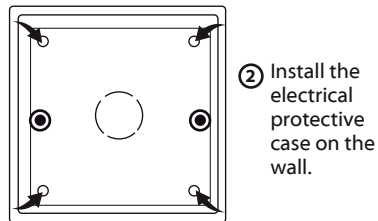

2 Install the electrical protective case on the wall.

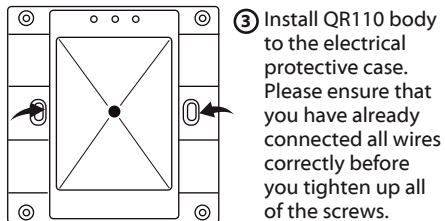

3 Install QR110 body to the electrical protective case. Please ensure that you have already connected all wires correctly before you tighten up all of the screws.

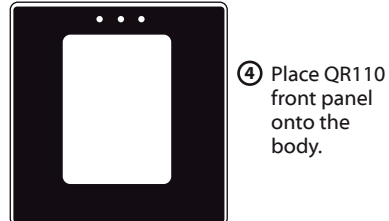

4 Place QR110 front panel onto the body.

4 Verification

QR110 reads the ID from the QR code or card and sends the information to the master terminal for verification. QR110 is a slave unit and it does not store any information. Therefore, card registration must be done at the master terminal only.

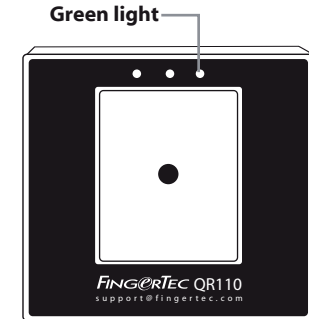
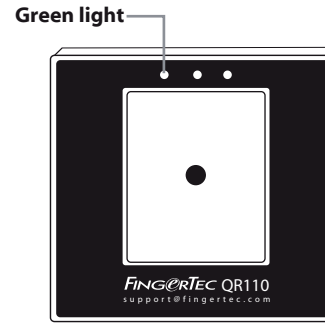

1 Make sure the device is on standby mode and ensure that you have created/enrolled the QR code/card at the master terminal prior to usage.

2 Present your QR code to the camera area for verification. If you are using card, wave the card at the card scanning area. Note that the LED light indicator will turn to green if the verification is successful.

5 Verification • Master terminal indication

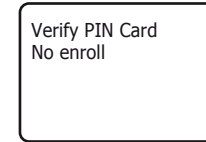
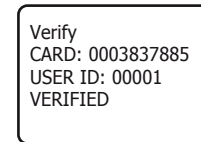

- 1 Once the master terminal verifies the QR code/card, the prompt "Verify" will be displayed.
- 2 If the QR code/card has not been enrolled or if there is something wrong with the QR code/card, the master terminal will prompt an "oo..oo.." sound indicating verification failure.